

THE COUNTY OF PEMBROKE



THE COUNTY OF PEMBROKE give notice that it intends to make the following Order under section 82, 83, 84 & 124 the Road Traffic Regulation Act 1984 as amended, as follows:

THE COUNTY OF PEMBROKE (VARIOUS ROADS) (SPEED LIMITS) AMALGAMATION ORDER 2023 (AMENDMENT NO.5) ORDER 2026

By amending The County of Pembroke (Various Roads) (Speed Limits) Amalgamation Order 2023, The effect of the proposals will be to:

- a) Introduce new, amend and/or revoke existing speed limits on those lengths of road listed in the Schedules to this notice.
- b) Replace all relevant Map Schedules with new revisions.

A copy of the proposed Order to which it relates, together with a statement of the Council's reasons for proposing to make the Order, may be inspected during normal office hours at County Hall, Freemans Way, Haverfordwest, Pembrokeshire SA61 1TP.

Alternatively, it can be viewed at the following website link: www.pembrokeshire.gov.uk/TRO-public-notice.

If you wish to object to the proposed Order you should send the grounds for your objection by either completing the online feedback form, or, in writing to the undersigned by the 10th day of June 2026. Please Quote: **AMAL 2023-A5-26**

Dated this 20th day of May 2026.

Sarah Oliver
Head of Transport & Operations
Pembrokeshire County Council
County Hall
Haverfordwest

SCHEDULE 1 20 MPH SPEED LIMIT

Ref.	Location and Road	Length of road
1.01.0	TENBY	
	Brynhir Estate Road	Entire Length

SCHEDULE 2 40 MPH SPEED LIMIT

Ref.	Location and Road	Length of road
1.01.0	TENBY	
	A478	From a point 12 metres north of the north entrance to the lay-by leading to Lady Park heading in a north eastly direction to a point 44 metres north of the Brynhir Estate Road. Approximately 394 metres.

Statement of Reason.

As part of the Brynhir development (North of Tenby) and access arrangements to the site, it is necessary to extend the existing 40mph limit on the A478 to avoid a conflict with the position of the terminal signs.

The extension of the limit on the A478 will be 9 metres in a north easterly direction from its existing position.

In addition, a new 20mph speed limit is proposed over the entire length of the new estate road.

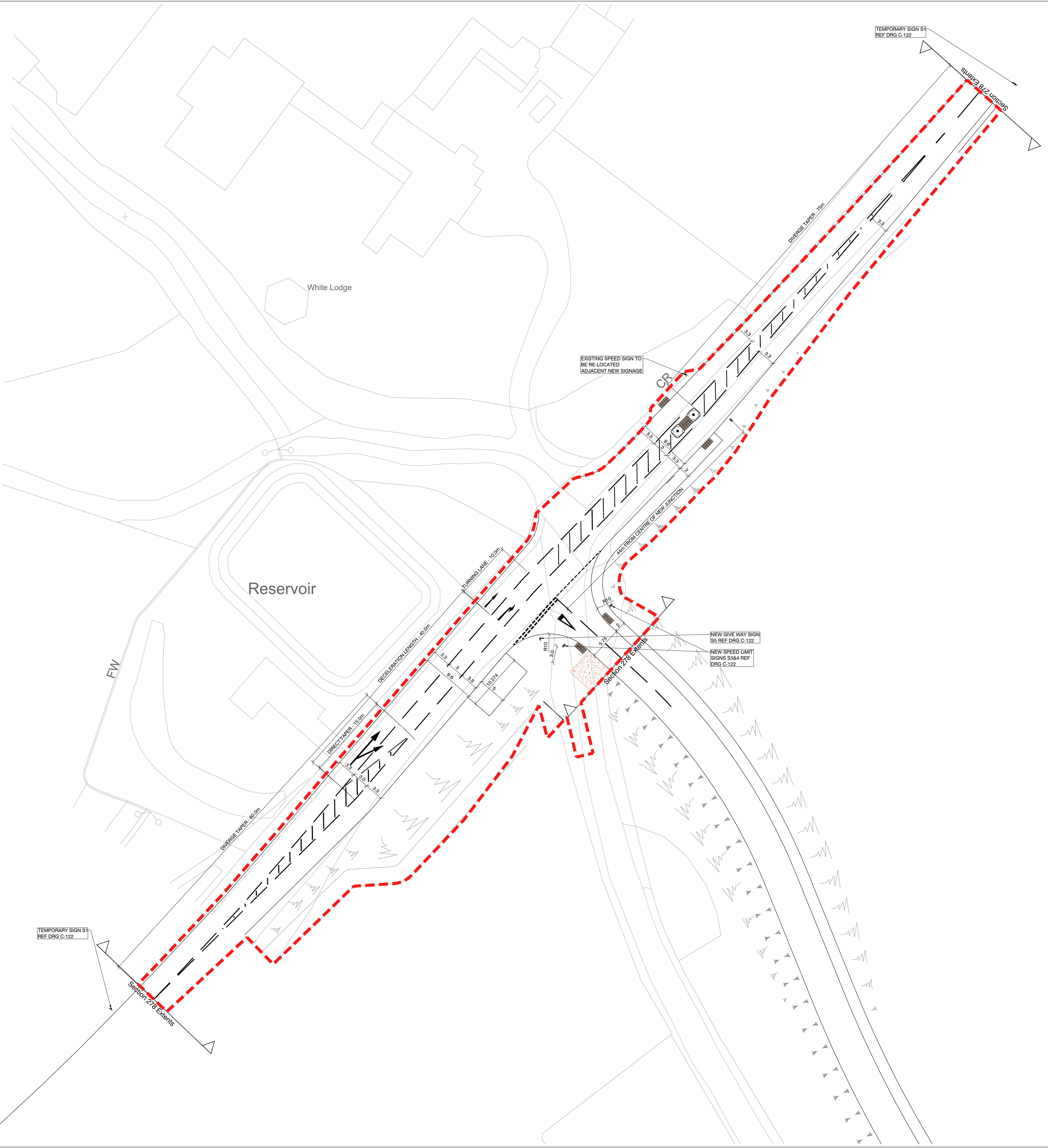

NOTES

DO NOT SCALE DRAWING. USE FIGURED DIMENSION (mm) ONLY.

ALL DIMENSIONS ARE TO BE CHECKED PRIOR TO CONSTRUCTION OR MANUFACTURE.

ALL DRAWING TO BE CHECKED PRIOR TO CONSTRUCTION OR MANUFACTURE. ANY DISCREPANCIES TO BE REPORTED TO THE ENGINEER IMMEDIATELY.

NO WORKS TO BEGIN WITHIN THE EXISTING HIGHWAY BEFORE RELEVANT ROAD OPENING NOTICES ARE APPROVED.

THIS DRAWING IS COPYRIGHT.

ALL CONSTRUCTION METHODS AND MATERIALS USED ARE TO BE IN ACCORDANCE WITH THE LATEST SPECIFICATION FOR HIGHWAY WORKS.

ALL SIGNS ARE TO BE BILINGUAL AND HAVE WELSH TRANSLATIONS.

CONCRETE GRADE USED FOR THE SIGN FORMATION TO BE ST.

BEFORE TRAFFIC SIGNS, POST SIZES AND CONCRETE FOUNDATIONS ARE INSTALLED OR ERECTED ON SITE THEY SHALL BE AGREED WITH THE HIGHWAY AUTHORITY'S MAINTENANCE MANAGER OR THE SITE REPRESENTATIVE AND THE TRAFFIC SIGNS SHALL BE ERECTED IN THEIR FINAL LOCATION PRIOR TO WORKS COMMENCING ON THE CONSTRUCTION OF THE ROAD NARROWING OR SPEED CUSHION.

ALL TRAFFIC SIGNS ARE TO BE ERECTED IN THEIR FINAL LOCATION PRIOR TO WORKS COMMENCING ON THE CONSTRUCTION OF THE ROAD HUMPS / NARROWING / SPEED CUSHIONS.

ALL CONSTRUCTION METHODS AND MATERIALS USED ARE TO BE IN ACCORDANCE WITH THE LATEST SPECIFICATION OF HIGHWAY WORKS. FOUNDATION RECOMMENDATIONS DESIGNED TO BS EN 12899 AND BS EN 1991-1-4.

ALL ROAD MARKINGS SHALL FULLY COMPLY WITH THE TRAFFIC SIGNS MANUAL CHAPTER 5 - ROAD MARKINGS 2003 - PUBLISHED FOR THE DEPARTMENT OF TRANSPORT UNDER LICENCE FROM THE CONTROLLER OF HIS MAJESTY'S STATIONARY OFFICE.

PRIOR TO ANY LINING / SIGNING WORKS COMMENCING ON SITE THE DEVELOPER SHALL SUBMIT FOR APPROVAL BY PCC HIGHWAY AUTHORITY. FULL ENGINEERING DETAILS OF ANY PROPOSED LINING / SIGNING DETAILS.

ALL PERMANENT AND TEMPORARY ROAD MARKING SHALL BE HOT APPLIED THERMOPLASTIC ROAD MARKING MATERIAL CONFORMING TO BS 3282: PARTS 1, 2 AND 3:1989.

ALL PERMANENT AND TEMPORARY ROAD MARKINGS LISTED WITHIN TABLE 23-1 (PAGE 143) OF THE TRAFFIC SIGNS MANUAL CHAPTER 5 - ROAD MARKINGS 2003 SHALL BE REFLECTORISED USING SOLID GLASS BEADS.

WHERE REGULATORY SIGNS ARE AS PART OF THE DEVELOPMENT THEY SHALL COMPLY WITH THE TRAFFIC SIGNS MANUAL CHAPTER 4 - ROAD SIGNS 2013 - PUBLISHED FOR THE DEPARTMENT FOR THE TRANSPORT UNDER LICENCE FOR THE CONTROLLER OF HIS MAJESTY'S STATIONARY OFFICE.

WHERE WARNING SIGNS ARE REQUIRED AS PART OF THE DEVELOPMENT THEY SHALL COMPLY WITH THE TRAFFIC SIGNS MANUAL CHAPTER 4 - ROAD SIGNS 2013 - PUBLISHED FOR THE DEPARTMENT FOR THE TRANSPORT UNDER LICENCE FOR THE CONTROLLER OF HIS MAJESTY'S STATIONARY OFFICE.

ALL TRAFFIC SIGNS SHALL BE DESIGNED IN ACCORDANCE WITH THE DESIGN OF TRAFFIC SIGNS MANUAL CHAPTER 7 - ROAD SIGNS 2013 - PUBLISHED FOR THE DEPARTMENT FOR TRANSPORT UNDER LICENCE FROM THE CONTROLLER OF HIS MAJESTY'S STATIONARY OFFICE.

GENERAL NOTES

- THIS DRAWING IS TO BE READ IN CONJUNCTION WITH AND CHECKED AGAINST ALL OTHER DRAWINGS, ENGINEERING DETAILS, SPECIFICATIONS AND ANY STRUCTURAL, GEOTECHNICAL OR OTHER SPECIALIST DOCUMENT PROVIDED.
- ANY DISCREPANCIES WITHIN ALL RELEVANT DRAWINGS ARE TO BE REPORTED TO QUADCONSULT LTD IMMEDIATELY.
- ALL DIMENSIONS AND LEVELS ARE IN METRES, U.N.O.
- DO NOT SCALE FROM THIS DRAWING - USE FIGURED DIMENSIONS ONLY.
- THIS DRAWING IS SCHEMATIC FOR CLARITY ONLY. POSITIONS OF PIPE RUNS AND MANHOLES MAY VARY ON SITE DUE TO SITE CONDITIONS.
- SURFACE WATER DRAINAGE SUBJECT TO S104 / S105 APPROVAL WHERE APPROPRIATE WITH THE RELEVANT AUTHORITY.
- FLOOD DRAINAGE SUBJECT TO S104 APPROVAL WITH RELEVANT WATER AUTHORITY.
- ALL PRIVATE DRAINAGE TO BE INSTALLED IN ACCORDANCE WITH PART H OF BUILDING REGULATIONS AND THE DEVELOPER'S WARRANTY PROVIDER.
- THE CONTRACTOR IS AT RISK IF CONSTRUCTION IS PROCEEDED WITHOUT RELEVANT S104, S106, S278, S38, OWC ETC AGREEMENT BEING IN PLACE WITH THE RELEVANT AUTHORITIES.

Enclosure

Rev	Date	Description	By												
<small>Dimensions to be verified on site. This drawing should not be scaled. Use figured dimensions only. Any discrepancies should be referred to the Engineer prior to work being put in hand. This drawing is copyright.</small>															
<small>QuadConsult Limited Columbus House, Village Way Cwmrobert Business Park, Cardiff CF15 7NE 029 2077 9644 contact@quadconsult.co.uk www.quadconsult.co.uk</small>															
Project BRYNHIR TENBY															
Title S278 SIGNING & LIGNING DETAILS															
Approval <table border="1"> <tr> <th>Designed by</th> <th>Drawn by</th> <th>Checked by</th> <th>Date</th> <th>Scale</th> <th>By A3 size</th> </tr> <tr> <td>CT</td> <td>CT</td> <td>JLZ</td> <td>04.02.26</td> <td>1:250</td> <td></td> </tr> </table>				Designed by	Drawn by	Checked by	Date	Scale	By A3 size	CT	CT	JLZ	04.02.26	1:250	
Designed by	Drawn by	Checked by	Date	Scale	By A3 size										
CT	CT	JLZ	04.02.26	1:250											
Drawing No 24247-C-136-0															

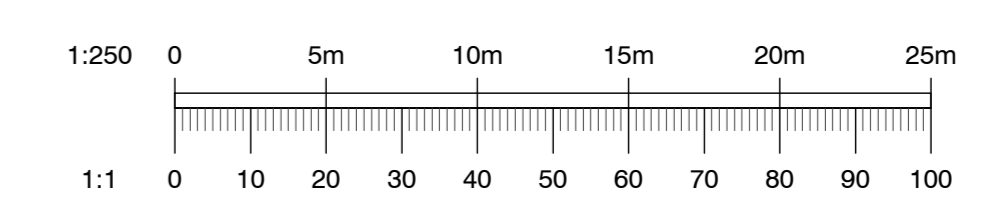

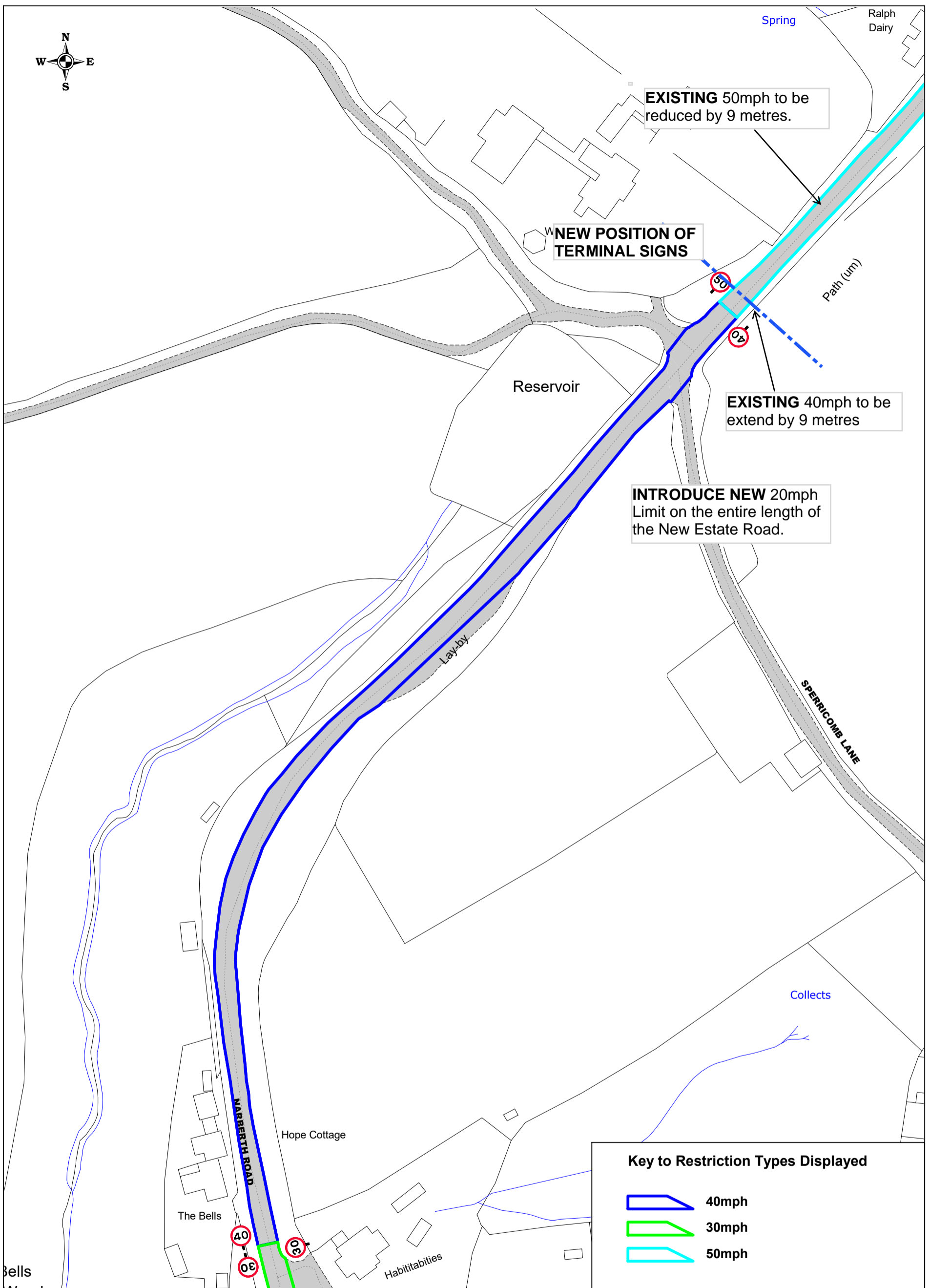

SCALE	1 : 1250
DATE	17/04/2026
DRAWING No.	A478 Existing 40mph.pdf
DRAWN BY	CAW

PEMBROKESHIRE COUNTY COUNCIL

**THE COUNTY OF PEMBROKE (VARIOUS ROADS) (SPEED LIMITS) AMALGAMATION ORDER 2023
(AMENDMENT NO.5) ORDER 2026**

The County of Pembroke, in exercise of the powers under Sections 82, 83, 84 and 124 of the Road Traffic Regulation Act 1984 as amended (“the Act”) and all other enabling powers, after consultation *inter alia* with the Chief Officer of Police in accordance with Part III of Schedule 9 of the Act hereby make the following order;

1. The County of Pembroke (Various Roads) (Speed Limits) Amalgamation Order 2023 shall be amended by the addition and revocation of the existing Schedules and hereby replaced, as set out in Schedule 1
2. The Order shall come into operation on **** 2026 and may be cited as The County of Pembroke (Various Roads) (Speed Limits) Amalgamation Order 2024 (Amendment No.5) Order 2026.
3. The Interpretation Act 1978 shall apply to this Order as it applies for the interpretation of an Act of Parliament.
4. Without prejudice to the validity of anything done or to any liability incurred in respect of any act or omission before the coming into operation of this Order, The County of Pembroke (Various Roads) (Speed Limits) Amalgamation Order (Amendment No.4) Order 2026 shall have effect as though:

**SCHEDULE 1
20 MPH SPEED LIMIT**

Ref.	Location and Road	Length of road
1.01.0	TENBY	
	Brynhir Estate Road	Entire Length

**SCHEDULE 2
40 MPH SPEED LIMIT**

Ref.	Location and Road	Length of road
1.01.0	TENBY	
	A478	From a point 12 metres north of the north entrance to the lay-by leading to Lady Park heading in a north eastly direction to a point 44 metres north of the Brynhir estate road. A distance of approximately 394 metres.

5. The remainder of the County of Pembroke (Various Roads) (Speed Limits) Amalgamation Order 2023 will remain in full force and effect.

Given under the Common Seal of the Pembrokeshire County Council

This **** 2026

**THE COMMON SEAL of the
PEMBROKESHIRE COUNTY COUNCIL
was hereunto affixed
in the presence of:-**

Authorised Signatory