

Sandy Hill Road Active Travel Scheme

PLACE: SAUNDERSFOOT



SANDY HILL SCHEME

- Provision of a continuous Shared Use Path route for pedestrians and cyclists between Sandy Hill and Stammers Road
- Forms Phase 3 of the overall wider scheme, connecting Sandy Hill with Saundersfoot Station.
- Proposal includes the following works:
 - Construction of circa 3.0m SUP for pedestrians and cyclists along Sandy Hill Road (for approximately 300m)
 - Section of SUP will be within new estate on upper Sandy Hill Lane (NP/22/0621/FUL), undertaken by developer
 - Provides direct link between Saundersfoot and A478, serving Broadfield Farm Holiday Park and Sea View Cottages (with 1.9m footway) and on-street cycling in this area
 - Traffic calming measures (such as kerb build-outs) to calm vehicles exiting the village
 - Raised table and junction narrowing at Sandy Hill Park to improve crossing points
 - Provision of raised table for uses across Sandy Hill Rd/Stammers Rd Junction and continuous 1.8m footway with Orca barrier separation.
 - Works expected to commence with funding from Welsh Government, following on from Phase 2.

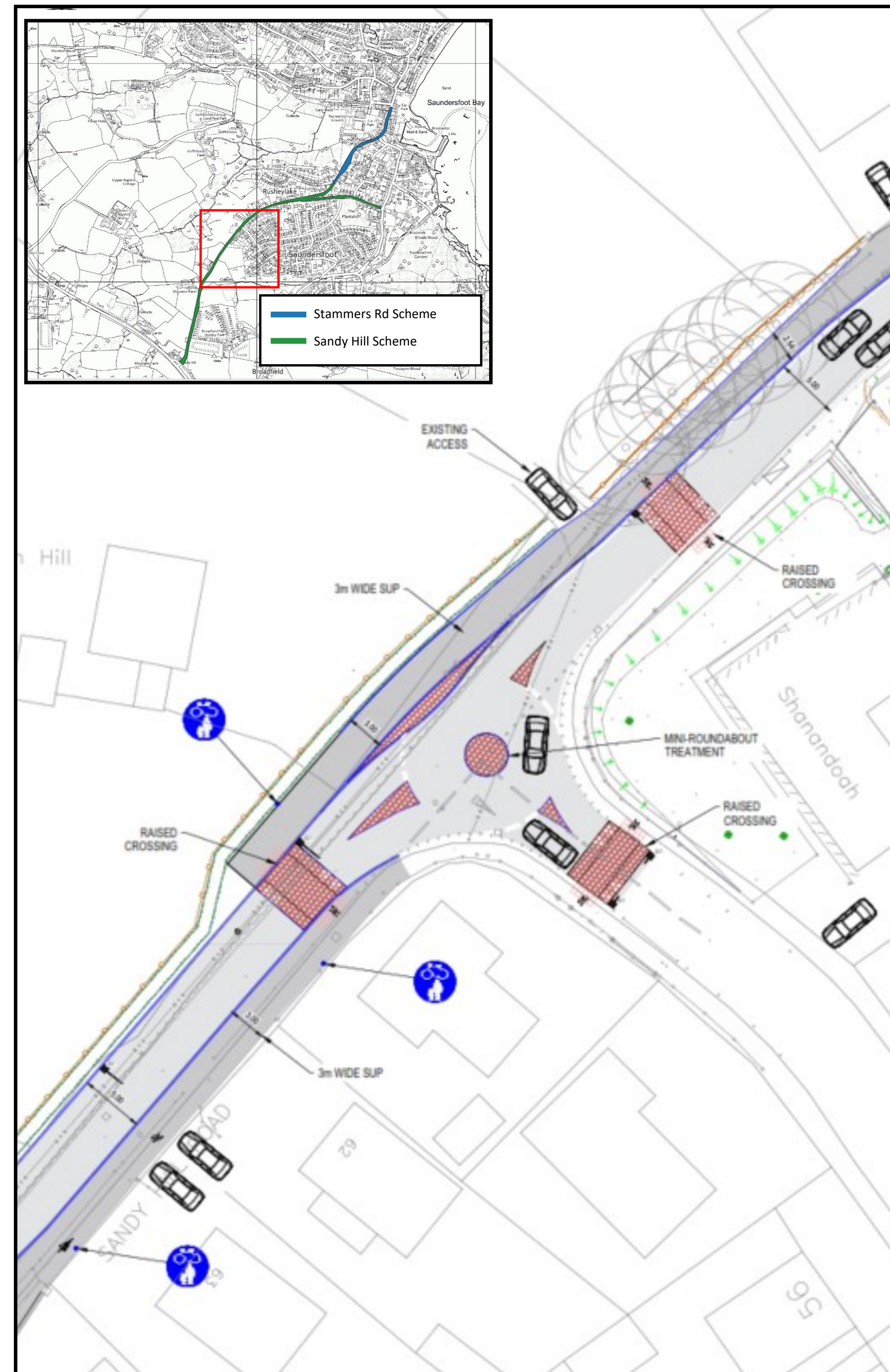
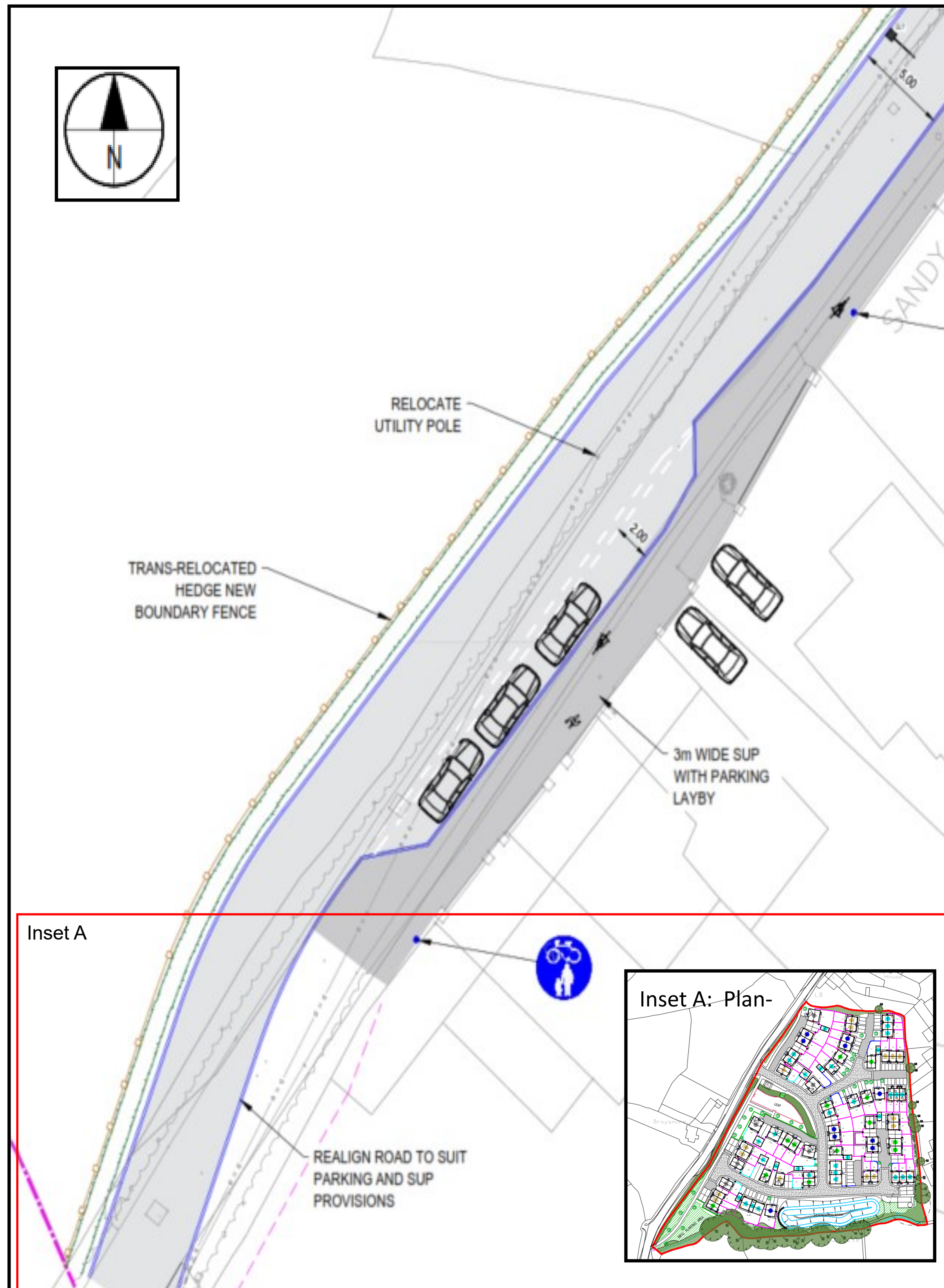

PCC Transport Strategy Team



Ariennir gan
Lywodraeth Cymru
Funded by
Welsh Government

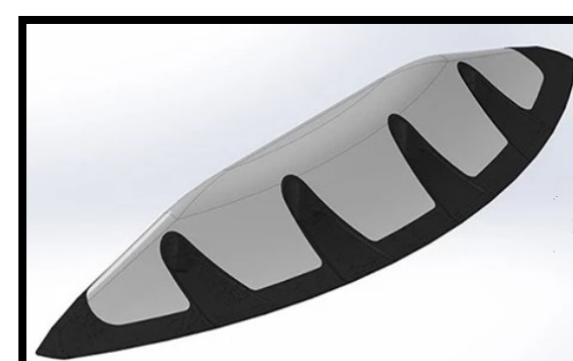

Examples of Orca Barriers, providing segregated cycle lanes—both with and without wands.