

PENWALLIS BUS ROUTING SCHEME—Plans

PLACE: Penwallis

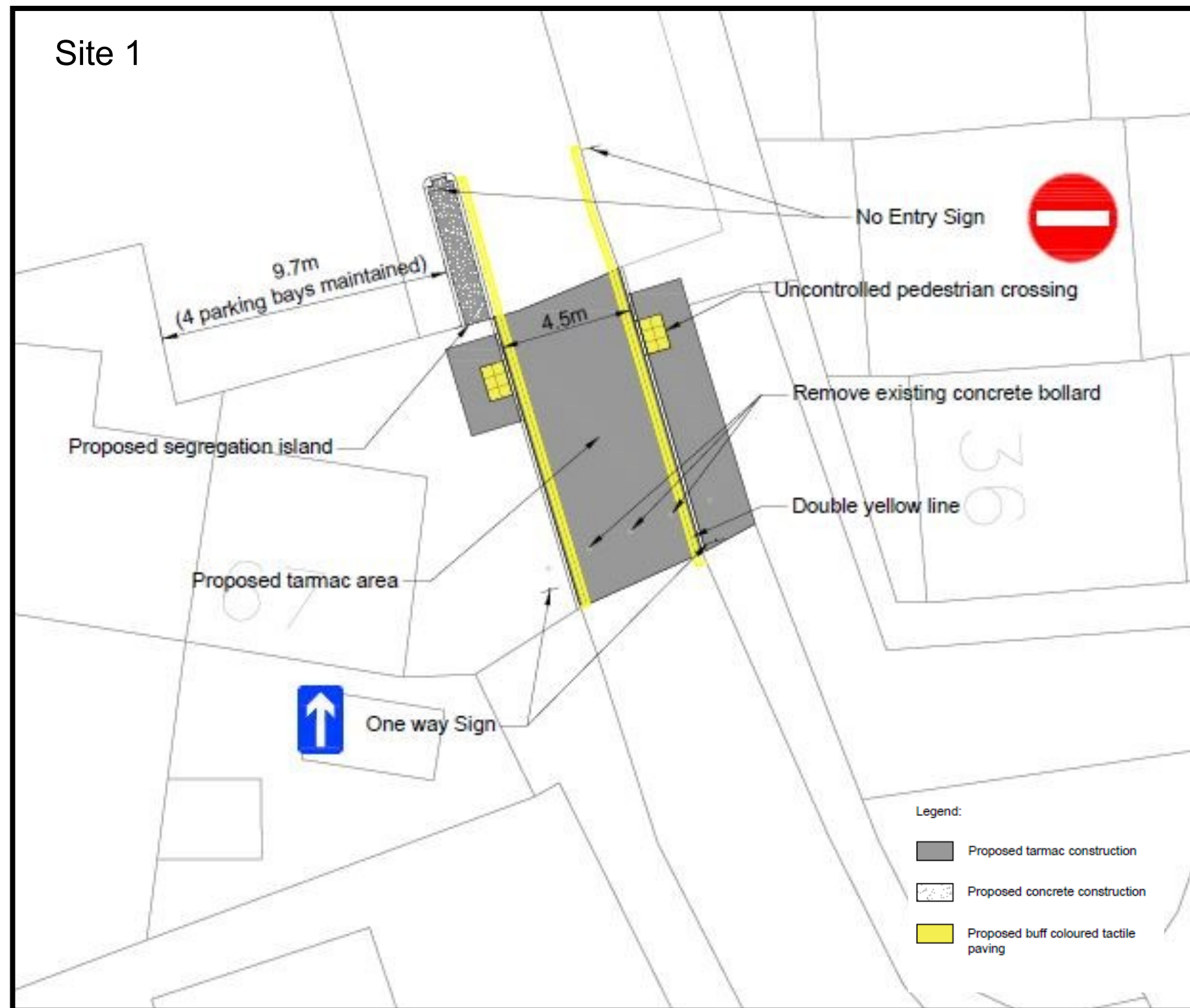

Site 1 Proposed Improvements:

- Remove existing grass area and turn into tarmac surface
- Construct uncontrolled pedestrian crossing
- Apply one way street order allowing one way traffic only
- Apply double yellow line parking order prevent on street parking
- Construct concrete island segregating resident's parking and traffic

Advantages:

- Access for all traffic are maintained
- Improve connectivity within in the estate

Disadvantages:

- May be used as a shortcut

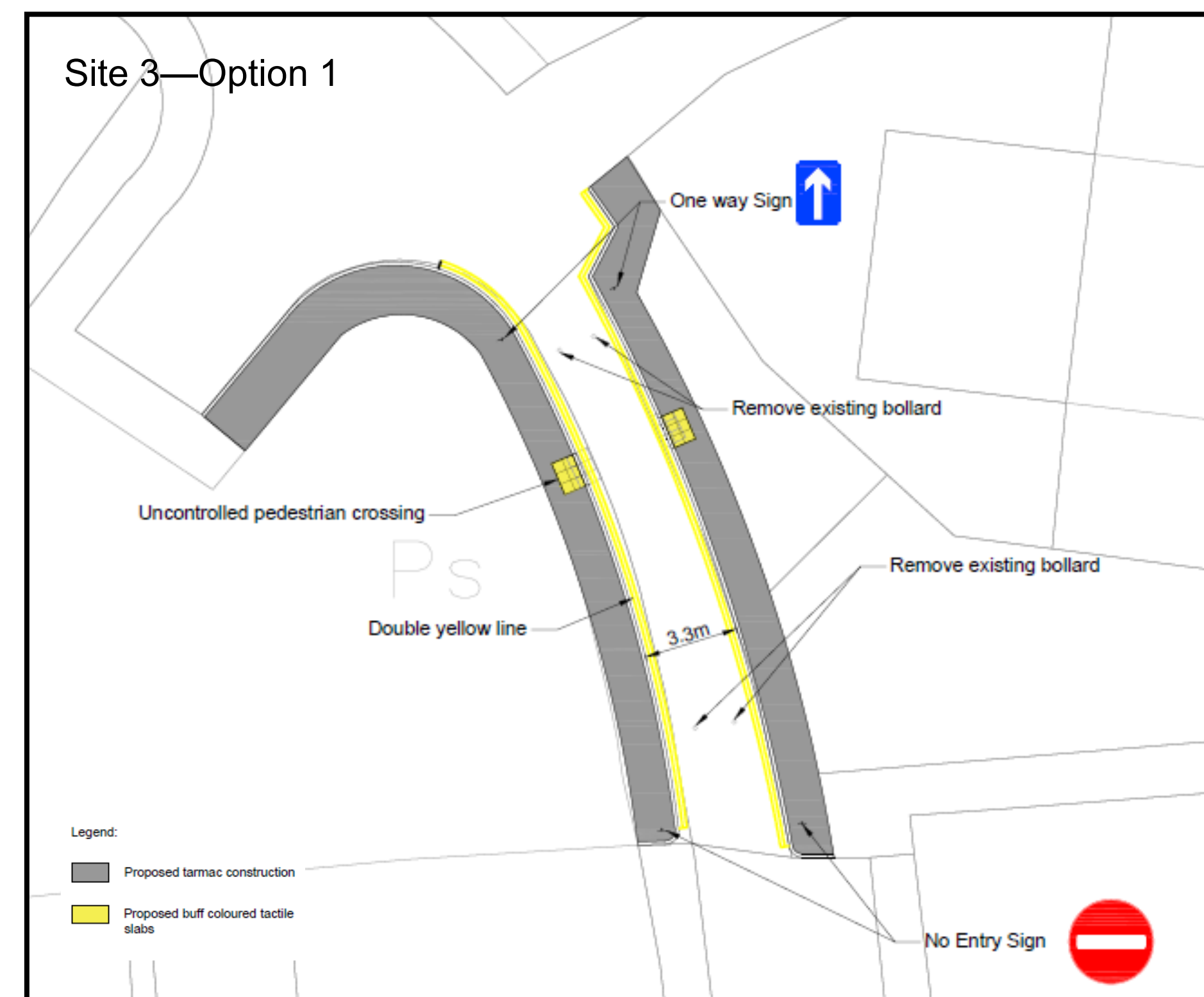
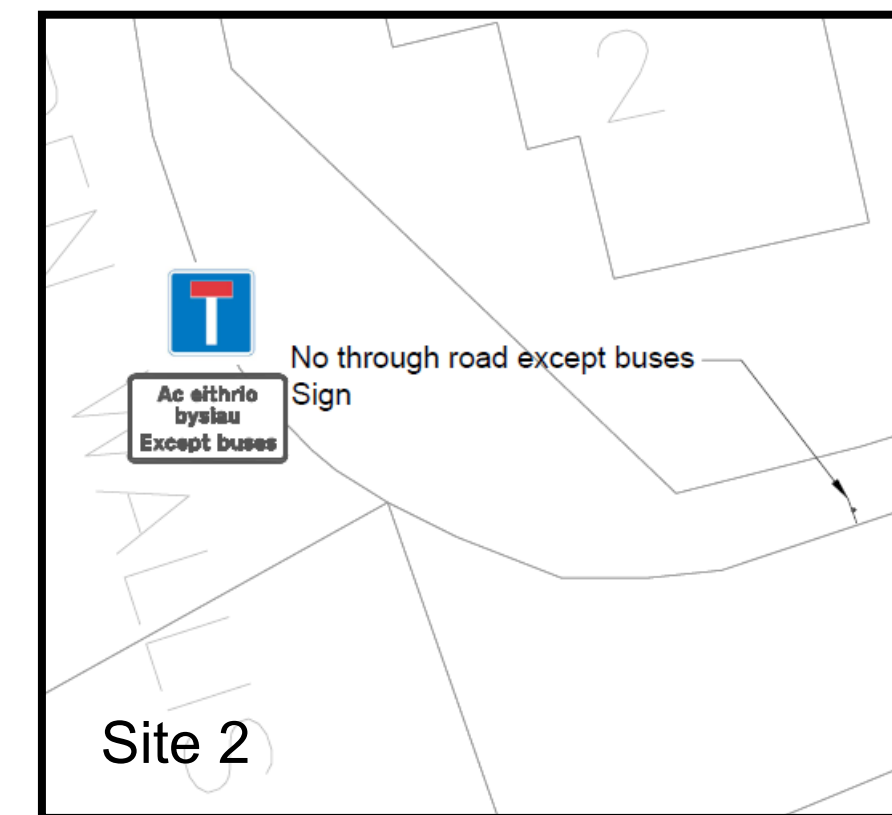

Site 3 Proposed Improvements—Option 1:

- Remove existing bollard and allow one way traffic
- Widen existing road

Advantages:

- All traffic are allowed to go through this section of road
- Improve connectivity within the estate

Disadvantage:

- May be used as a shortcut

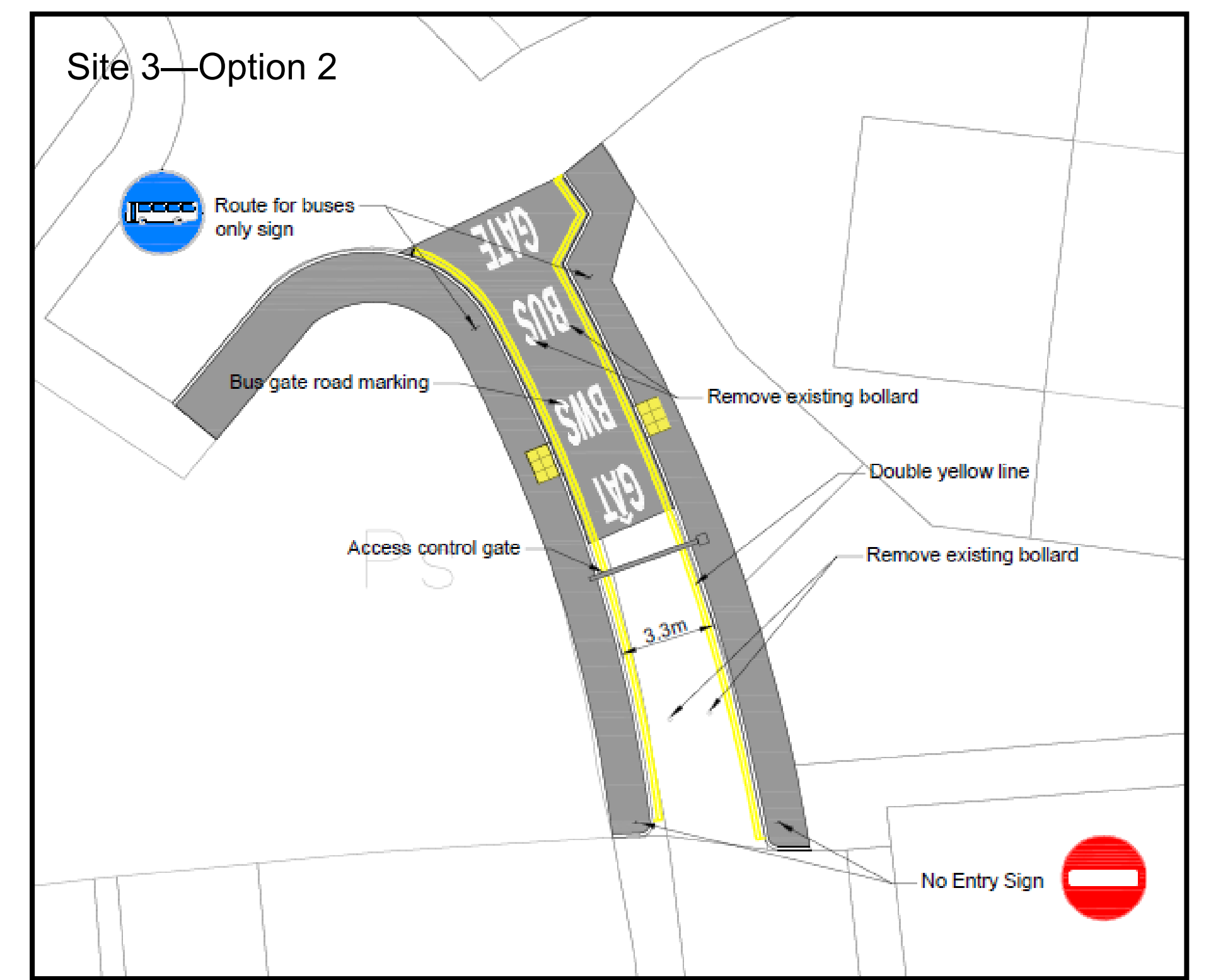

Site 3 Proposed Improvements—Option 2:

- Remove existing bollard and turn into a bus gate
- Widen existing road
- Install barrier gate to control access

Advantages:

- Only authorised vehicles can access
- Prevent traffic using as a shortcut

Disadvantages:

- Unauthorised vehicles have to turn around at this location
- No vehicles can pass through if unexpected break down



PCC Transport Strategy Team



Ariennir gan Lywodraeth Cymru
Funded by Welsh Government